

PARTS LIST

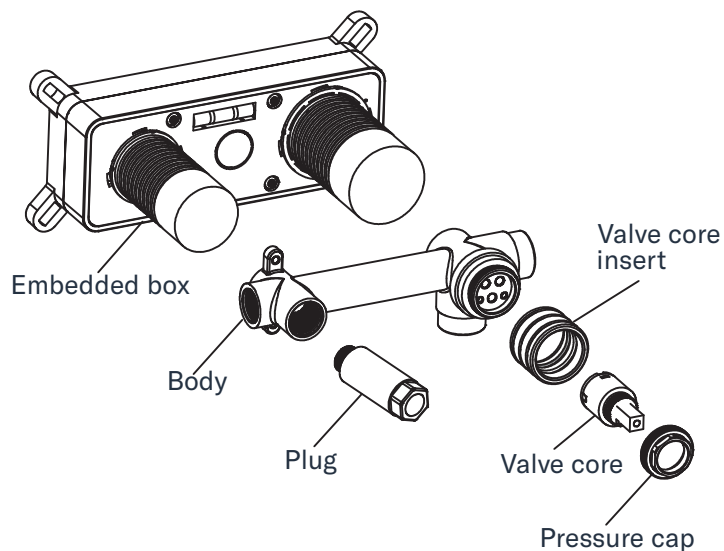

DIMENSIONAL DRAWING

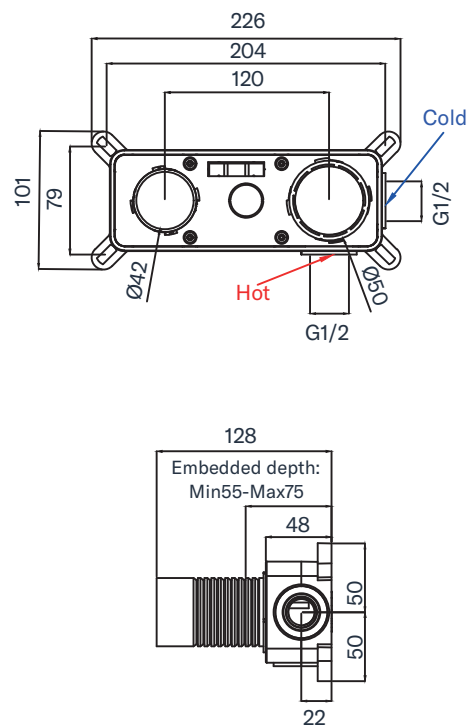

INSTALLATION STEPS

01

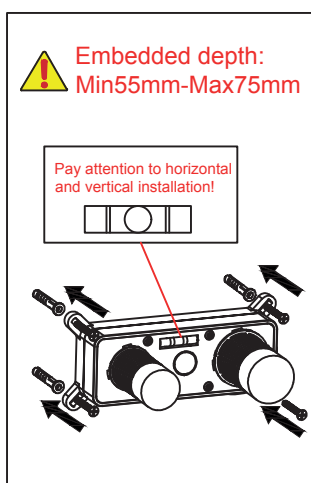

DIG THE EMBEDDED HOLE IN THE WALL, THE EMBEDDED DEPTH IS MIN55MM-MAX75MM. (NOTE:DEPTH DIMENSION IS REFERS TO THE WALL WITH PAVED TILE, AND PLEASE RESERVE APPROPRIATE TILE THICKNESS IF INSTALLED ON THE BLANK WALL). INSTALL THE EMBEDDED BOX INTO THE EMBEDDED HOLE WITH EXPANSION RUBBER PARTICLES AND SELF-TAPPING SCREWS, AND CHECK WHETHER THE LEVEL IS LEVEL.

02

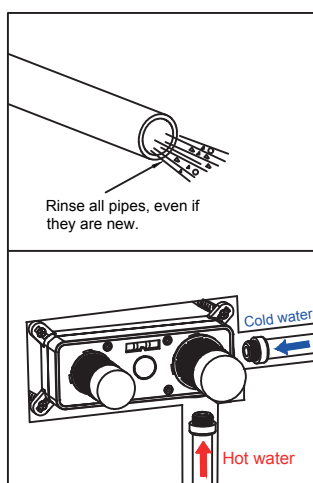

RINSE ALL PIPES, CONNECT THE COLD AND HOT WATER PIPES, PAYING ATTENTION TO DISTINGUISHING THE DIRECTION OF THE COLD AND HOT WATER PIPES.

03

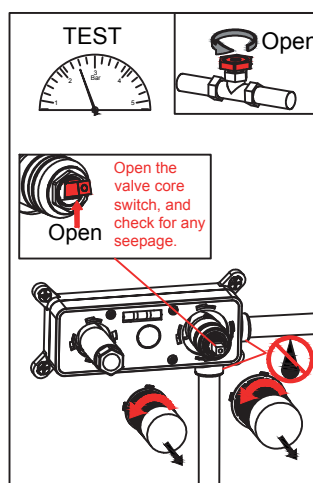

TAKE OUT THE ROUND COVER OF THE EMBEDDED BOX, OPEN THE WATER VALVE SWITCH, OPEN THE VALVE CORE SWITCH, AND CHECK FOR ANY SEEPAGE.

04

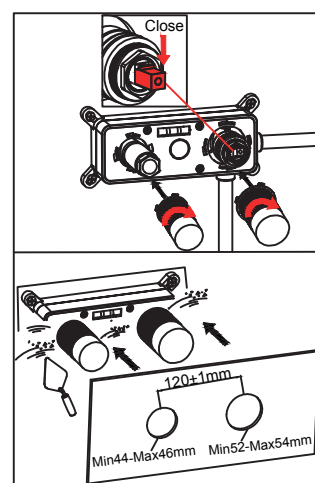

INSTALL THE ROUND LID OF THE EMBEDDED BOX. SEAL THE WALL AND LAY TILES (NOTE THE SIZE THE TILE OPENING).