

> SIZES IN MM.



#### TECHNICAL INFORMATION

COLLECTION: PLUMBING /HEALTH SPRAY  
PRODUCT TYPE: HEALTH SPRAY ABS  
MATERIAL: ABS  
CONNECTION SIZE: 1/2"  
WATER PRESSURED: 0.2-0,5 BAR  
RMP: 1.0 BAR LP

#### CODE & COLOUR

**HSA-ROU**  
Please refer to the product  
details on our website  
for colour references:  
[iwandw.com](http://iwandw.com)

#### SCOPE OF DELIVERY

HEALTH SPRAY · ABS BODY · ONE SPRAY FUNCTION  
HOLDER, PVC HOSE 1.2m & ROUND ANGLE VALVE  
INCLUDED · INSTALLATION GUIDE  
CARE & MAINTENANCE MANUAL

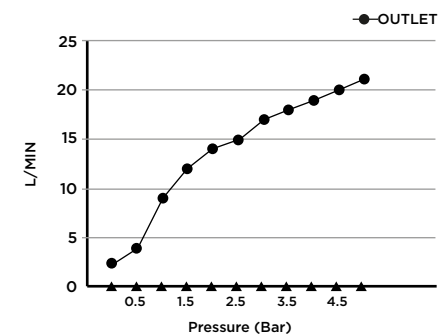

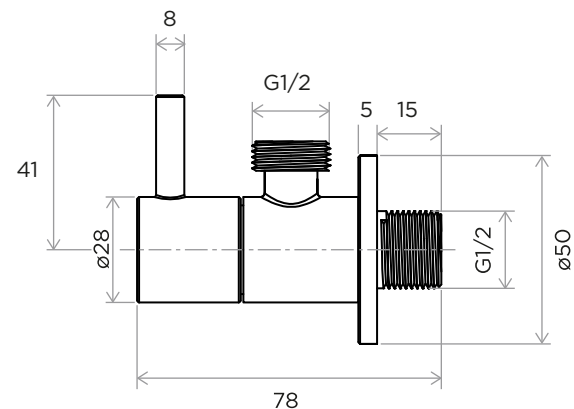

> SIZES IN MM.



#### TECHNICAL INFORMATION

COLLECTION: ANGLE VALVE  
PRODUCT TYPE: A/V ROUND  
MATERIAL: BRASS  
CONNECTION SIZE: 1/2"  
WATER PRESSURED: 0.2-0,5 BAR  
RMP: 1.0 BAR LP  
IN ACCORDANCE WITH ASME 112.18.1

#### CODE & COLOUR

**A/V-ROU**  
Please refer to the product  
details on our website  
for colour references:  
[iwandw.com](http://iwandw.com)

#### SCOPE OF DELIVERY

ANGLE VALVE  
BACK PLATE  
CARE & MAINTENANCE MANUAL

